

# UrbanShade™ System

## Competitively priced high design

The new-generation UrbanShade™ system is a competitively priced, high-design window covering. It's easily reconfigured in the field for special site conditions. The system is suitable for smaller spaces, residences, light-commercial projects, home theaters, and A/V and conference areas. Featuring high-quality and durable components, UrbanShade™ is ideal when aesthetics, flexibility, and competitive pricing are desirable. UrbanShades™ are available as standard components assembled on-site or as prefabricated cassettes.

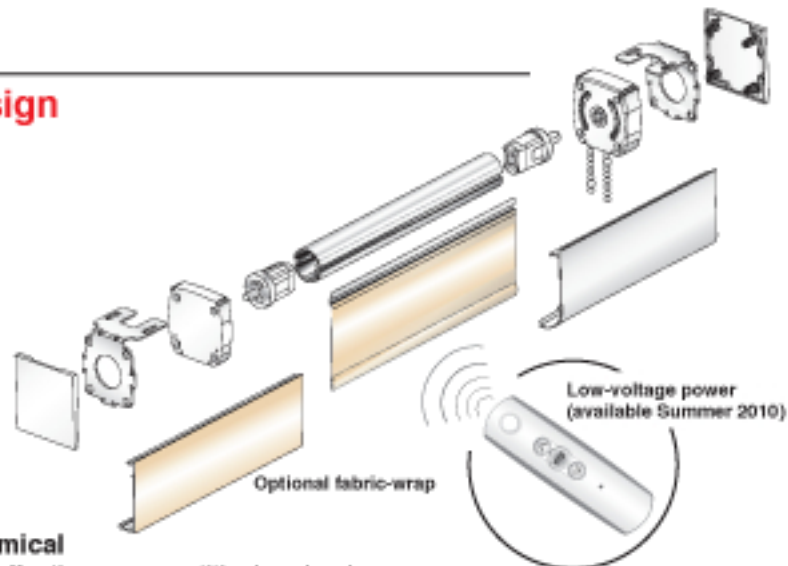

### Economical

- Cost effective—competitively priced

### Configurations

- Manual—smooth operation with a continuous bead chain
- Motorized—battery powered with RTS wireless IR remote control
- Motorized—low voltage with wireless RTS + dry-contact control

### Reliability

- Sturdy—heavy-duty steel support brackets with high-density plastic components
- Durable—rigid mounting brackets with a steel frame
- Powerful—allows for shades up to 10 ft. (305cm) high
- Longevity—ten-year non-depreciating warranty

### Design attributes

- Versatile—integrated and interchangeable components
- Flexible—universal mounting bracket, enabling on-site reconfiguration
- Compact—small-edge clearance with 3/8 in. (9.5mm) space
- Sleek—refined, unobtrusive profile

### Easy installation

- Innovative—universal mounting brackets (wall, ceiling, or jamb)
- Adaptable—Left and right drives are interchangeable.
- Straightforward—Optional cassette allows for fast and easy installations
- Cassette—prefabricated, fully assembled
- Accessible—SnapLoc® spline for easy shadecloth removal and maintenance

### Controls

- Operation—wireless RTS or hard wired low-voltage.
- Interoperative—allows for wireless RF/RTS or IR control
- Dry-contact—daisy-chained manual switch control

### Options

- Decorative—SnapLoc® fascia as square or radius. Optional fabric-wrapped fascia
- Room-darkening—side and sill channels
- Lift assist mechanism available as required for heavier shades

## UrbanShade™ Fascia options

### Fascia colors:

- White (WH)
- Colonial White (CW) (Square Fascia Only)
- Alabaster (AL) (Radius Fascia Only)
- Clear Anodized Aluminum (CA)
- Grey (GR)
- Quaker Bronze (QB)
- Black (BK)

(Fabric-wrapped Fascia will match shadecloth color, however fabric covered End Caps are not available)

### Square Fascia

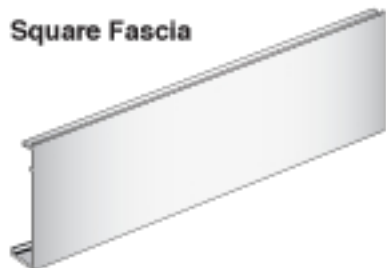

### Radius Fascia

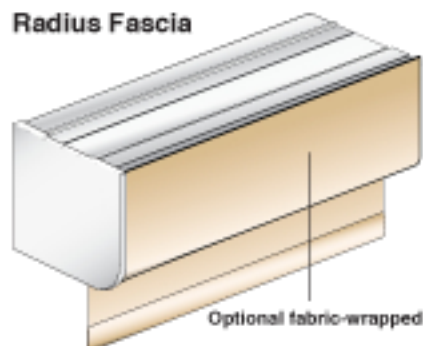

## Bypass Fascia

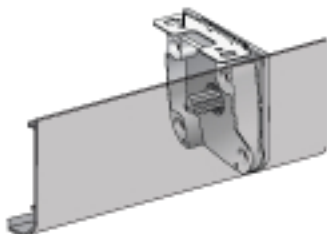

Available in Square or Radius Fascia

## Captured Fascia

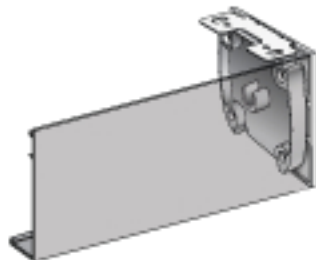

Available in Square or Radius Fascia

## Jamb Bypass Fascia

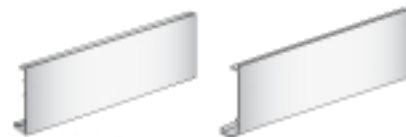
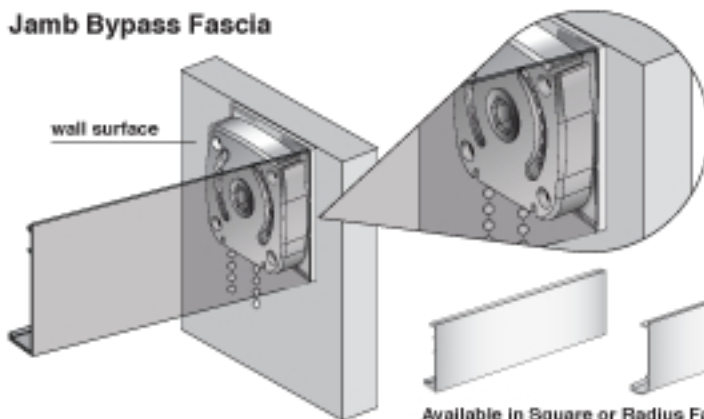

Available in Square or Radius Fascia

## Jamb Captured Fascia

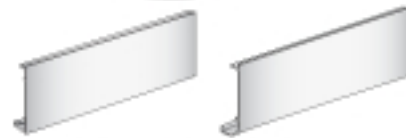
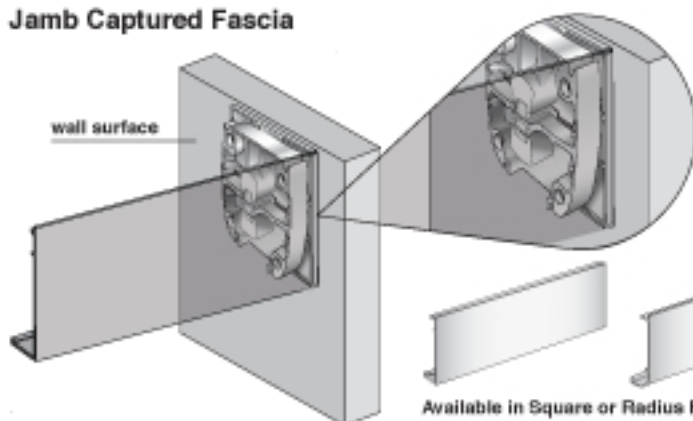

Available in Square or Radius Fascia



# UrbanShade™ System

## High-tech manual or motorized solar-shade system

### Shade prices include:

One pair of universal UrbanShade™ brackets, chain, shade cloth with fabric-covered hembar, SnapLoc® spline and a 1¼ in. or 1½ in. SnapLoc® tube. Railroaded shade cloths are fabric turned width for height.

### Optional accessories include:

SnapLoc® fascia and a chain retainer. Battery Powered Motor option and accessories. Room-darkening side channels. Room-darkening side channels.

### Optional SnapLoc® Fascia available with:

- Square or Radius
- Continuous or Captured End Caps
- Baked enamel or Optional Fabric-wrapped (fabric covered End Caps are not available)

- ⊕ Standard ⊕ Optional
- 1 End Plate
  - 2 Concealed Steel Mounting
  - 3 Idle-End Housing
  - 4 Screws
  - 5 Idle-End Tube Plug
  - 6 SnapLoc® Tube
  - 7 Drive-End Tube Plug
  - 8 Drive-End Housing for Manual Shades
  - 9 Upper and Lower Bead Chain Stops for Manual Shades
  - 10 Bead Chain Connector for Manual Shades
  - 11 Chain Retainer for Manual Shades
  - 12 Spring-Loaded Tension Pulley Chain Retainer for Manual Shades (O)
  - 13 SnapLoc® Mini-Spline
  - 14 Hembar (Standard cloth covered)
  - 15 SnapLoc® Regular-Roll Fascia—Square (O)
  - 16 SnapLoc® Regular-Roll Fascia—Radius (O)
  - 17 Round Fascia Jamb Mount Captured End Plate (O)
  - 18 Round Fascia Captured End Plate (O)
  - 19 Square Round Fascia Continuous Backplate (O)
  - 20 No Fascia Backplate (O)
  - 21 Square Round Fascia Jamb-Mount Continuous End Plate (O)
  - 22 Universal Exposed Hembar (O)
  - 23 Optional Weight (O)
  - 24 Finial—Standard (O)
  - 25 Finial—For use with Guide Cables (O)
  - 26 Room-Darkening Side Channel (single) (O)
  - 27 Room-Darkening Shadecloth Guides (pair) (O)

(O) = Optional

\* Not available on UrbanShade™ Cassette option.

### Exploded view

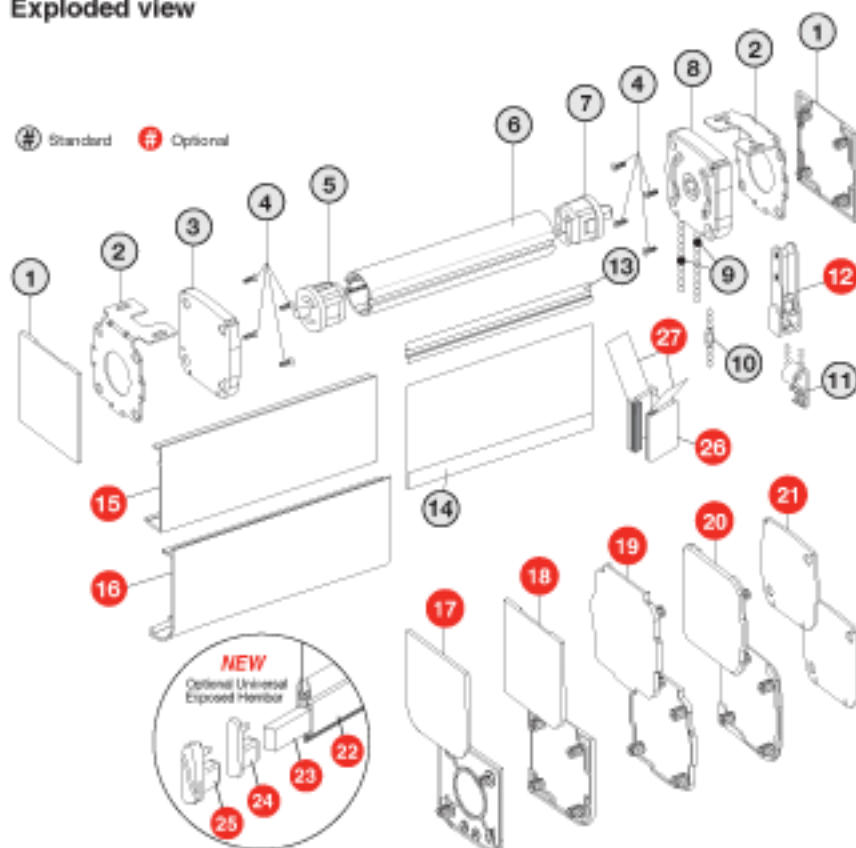

### Universal mounting

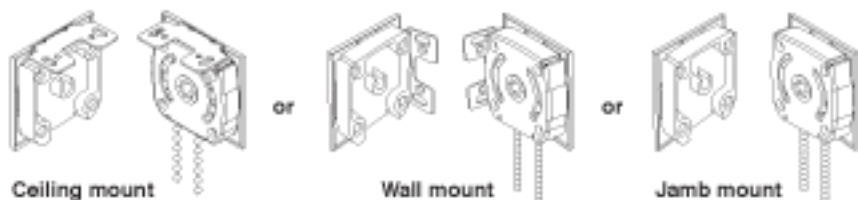

## Specifications

Dimensions: mounting brackets	<ul style="list-style-type: none"><li>• 2-3/4 in. deep x 2-3/4 in. high</li></ul>
Mounting	<ul style="list-style-type: none"><li>• Wall, ceiling, or jamb mounting. Reconfigurable on-site, truly universal.</li></ul>
Bracket description	<ul style="list-style-type: none"><li>• Heavy duty zinc plated steel encased in a high impact, decorative matte finish composite housing.</li></ul>
Roll up diameter (RUD)	<ul style="list-style-type: none"><li>• 2.46 in. allows shades of 9 ft. or higher</li></ul>
Edge Clearances	<ul style="list-style-type: none"><li>• Drive end 11/16 in.</li><li>• Idle end 5/8 in.</li></ul>
Hardware options	<ul style="list-style-type: none"><li>• Continuous or captured end caps</li><li>• Lift assist mechanism (LAM)</li><li>• Room-darkening side channel</li><li>• Standard cloth covered hembar</li><li>• Optional universal exposed hembar</li></ul>
Hardware color options	<ul style="list-style-type: none"><li>• White, Grey, or Black</li></ul>
Fascia options	<ul style="list-style-type: none"><li>• Square, radius, and painted or fabric wrapped</li></ul>
Fascia color options	<ul style="list-style-type: none"><li>• White, Clear anodized aluminum, grey, quaker bronze, or black and colonial white in square only and alabaster in radius only</li></ul>
Lift capacity (manual shade)	<ul style="list-style-type: none"><li>• 11 lbs. (5kg) of shadecloth with LAM</li></ul>
Maximum width, single band	<ul style="list-style-type: none"><li>• 96 in.</li></ul>
Multi-banding option	<ul style="list-style-type: none"><li>• Will save 3/8 in. of edge clearances between drive and idle ends of a multibanded shade. Contact your local MechoShade Systems Representative for availability.</li></ul>
Motorization options	<ul style="list-style-type: none"><li>• Battery powered, wireless, capacity is approx 6 lbs.</li><li>• WhisperShade™ low voltage, 2Nm tubular motor (approx 17 lbs.), wireless. Contact your local MechoShade Systems Representative for availability.</li></ul>
Warranty	<ul style="list-style-type: none"><li>• Ten-year non-depreciating warranty</li></ul>

